



**Drammen kommune**  
Dato 15.03.2011  
Målestokk 1:1000



Utomhusplan  
Gundesølina 10  
Skoger skole

Oppdatert 24.05.24

- 1  Ingen brøytekant v. flaggsteng.
- 2  — 1,7 — v. Kontainer

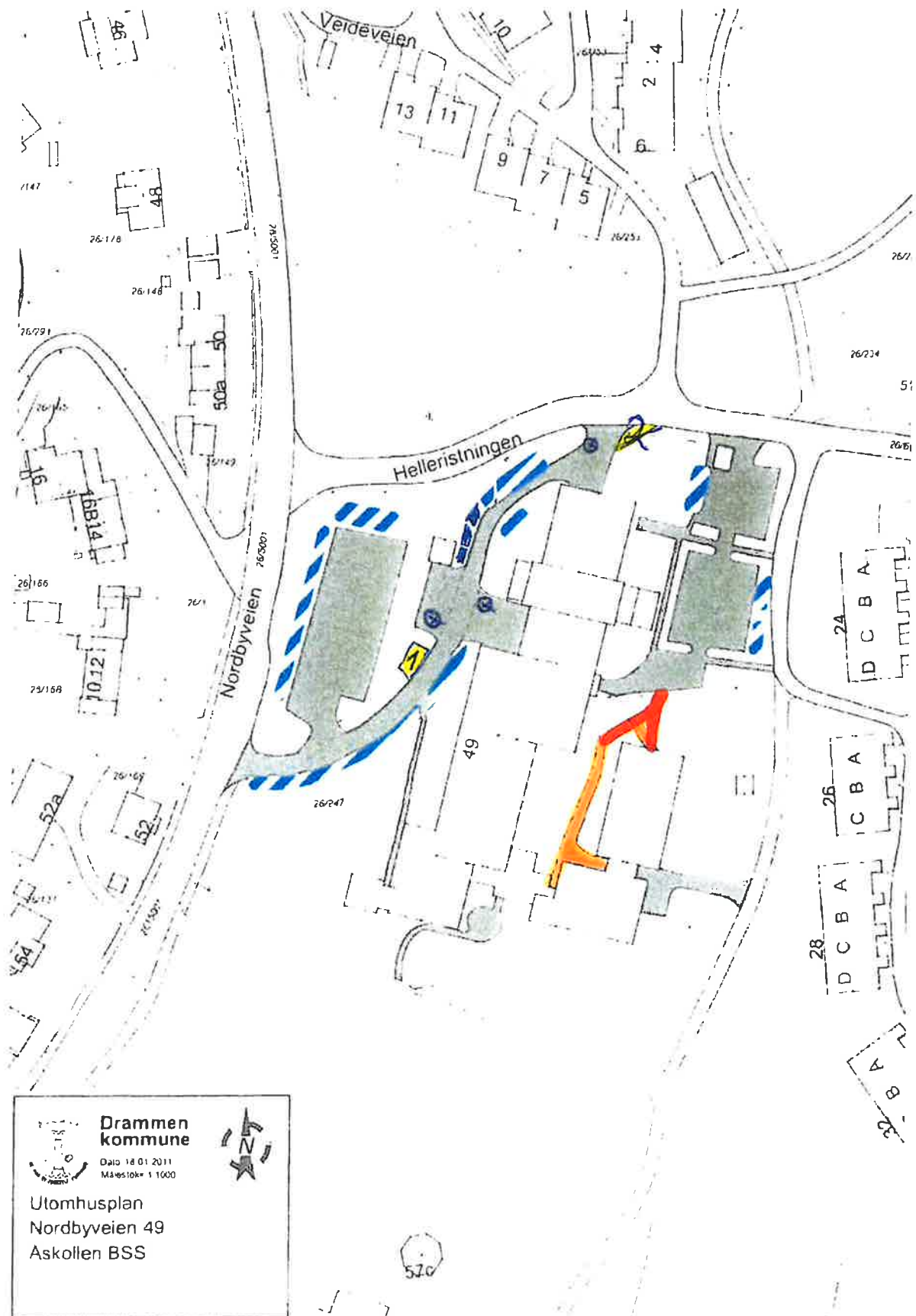

Oppdatert 24.05.24

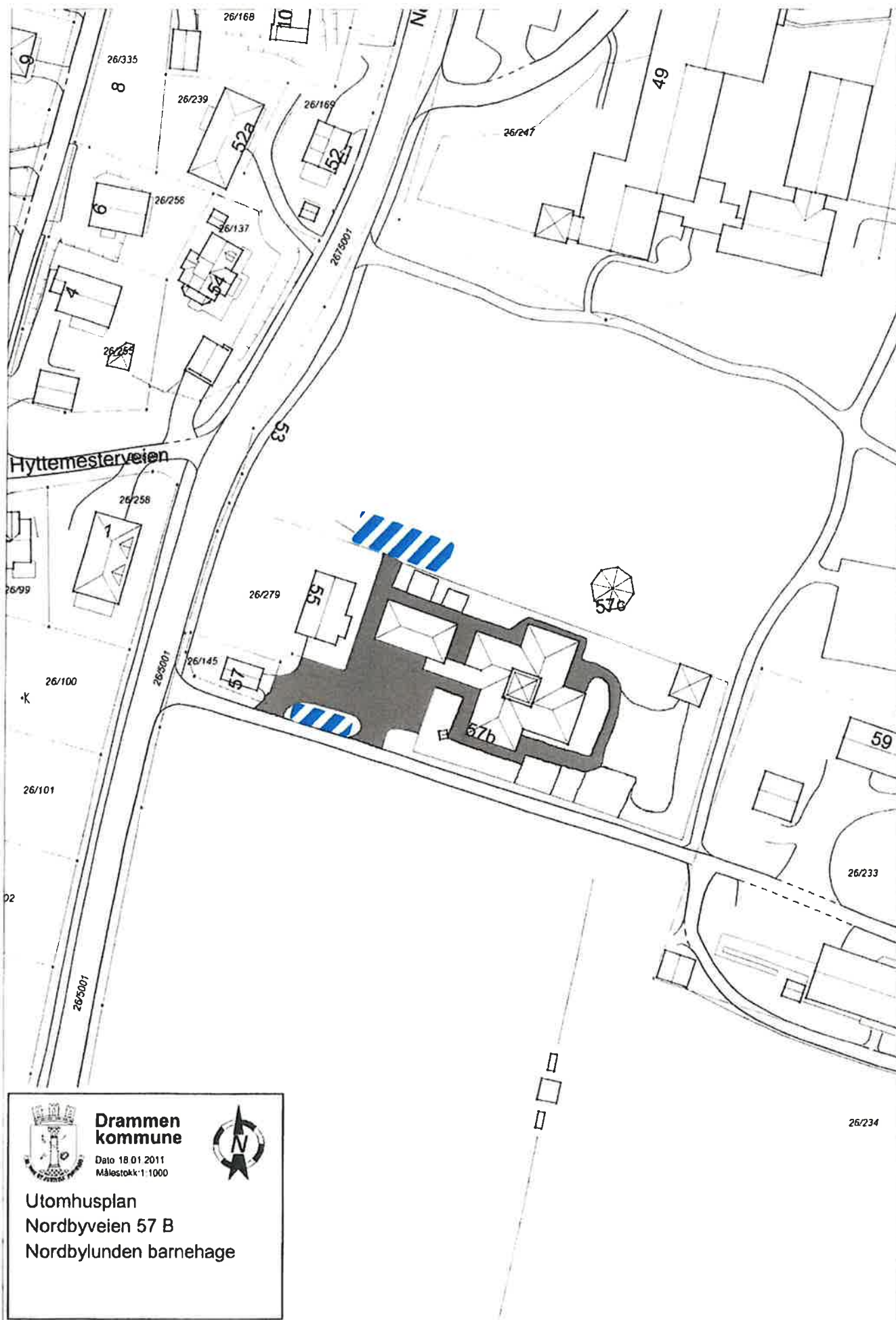

**Drammen  
kommune**



Dato 18.01.2011  
Målestokk 1:1000



Utomhusplan  
Nordbyveien 57 B  
Nordbylunden barnehage

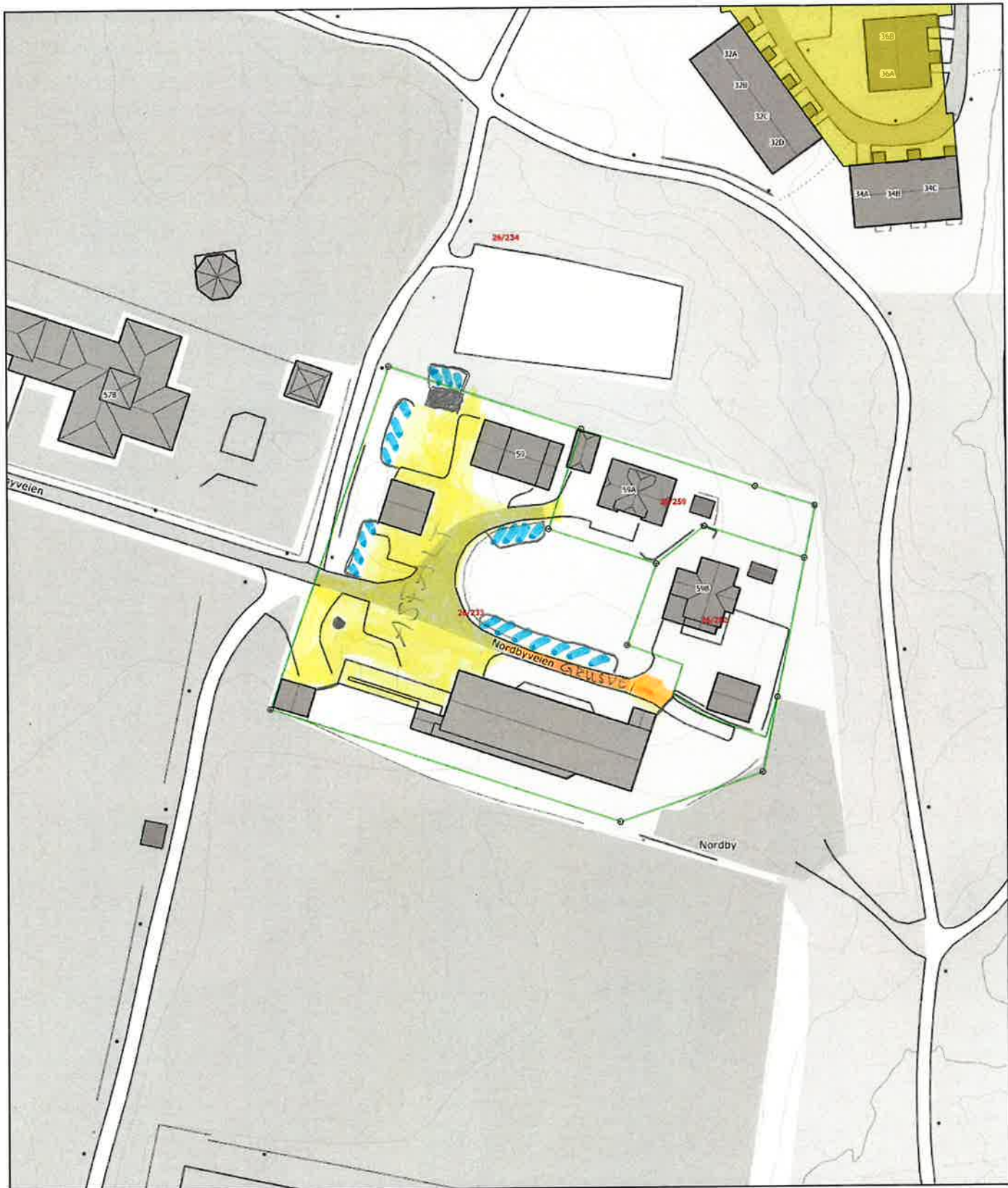



 <b>DRAMMEN</b> <b>KOMMUNE</b>	<h1>Nordby gård barnehage og boliger</h1>		 <b>N</b>
	Nordbyveien 59	 = asfalt  = grus  = svørlager	
	Dato: 14/9-2021		
	Sign:		
		Målestokk: 1:1000	Format A4

Det tas forbehold om evt. feil/mangler i kartgrunnlaget. I forbindelse med prosjektering/anleggsarbeid må aktuelle faginstans i kommunen kontaktes.

Ny Trapp/endring

Ny Rømningsvei

⊗ Sluk/overvannsmist

oppstillings plass ved brann

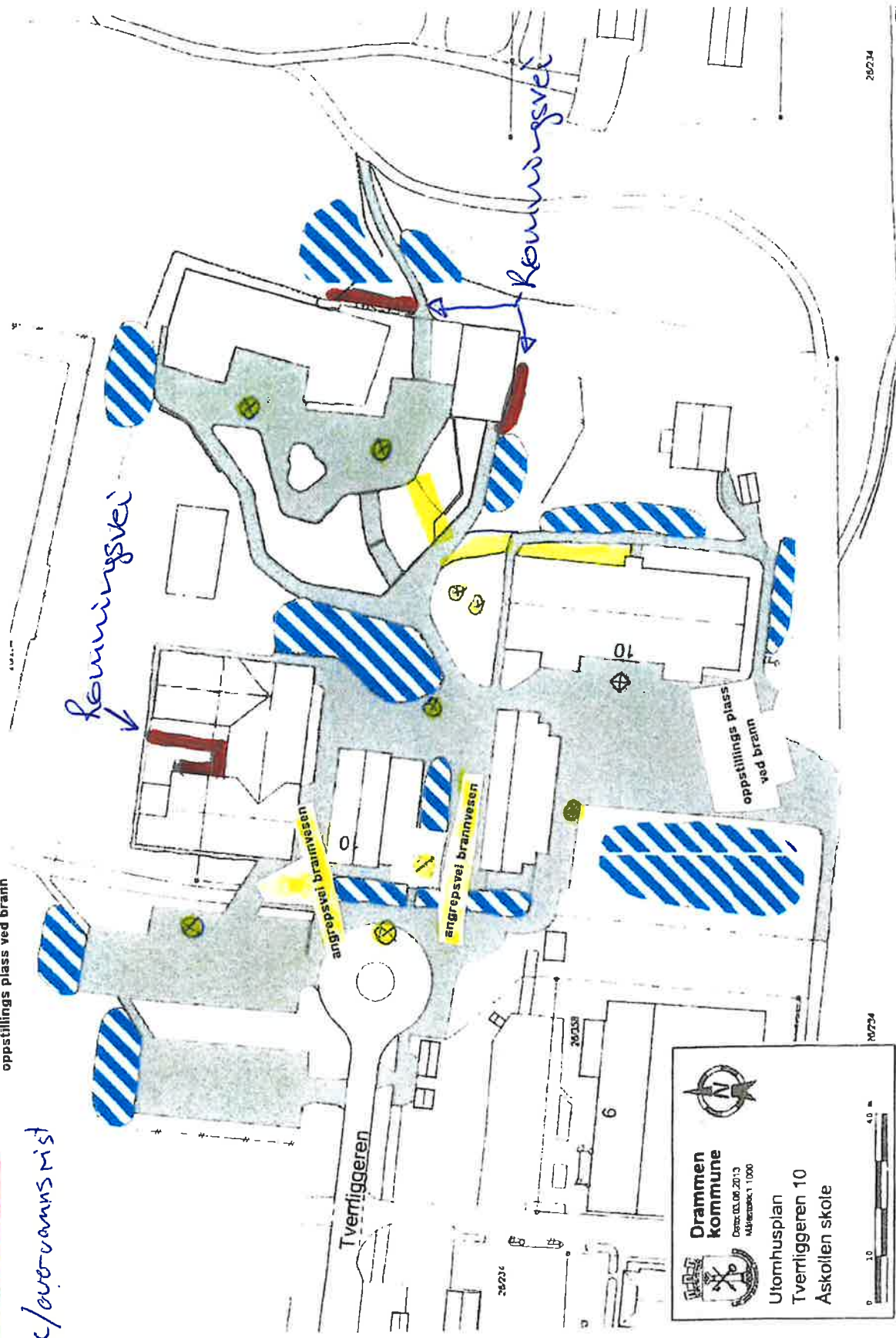

Oppdatert 24.05.24



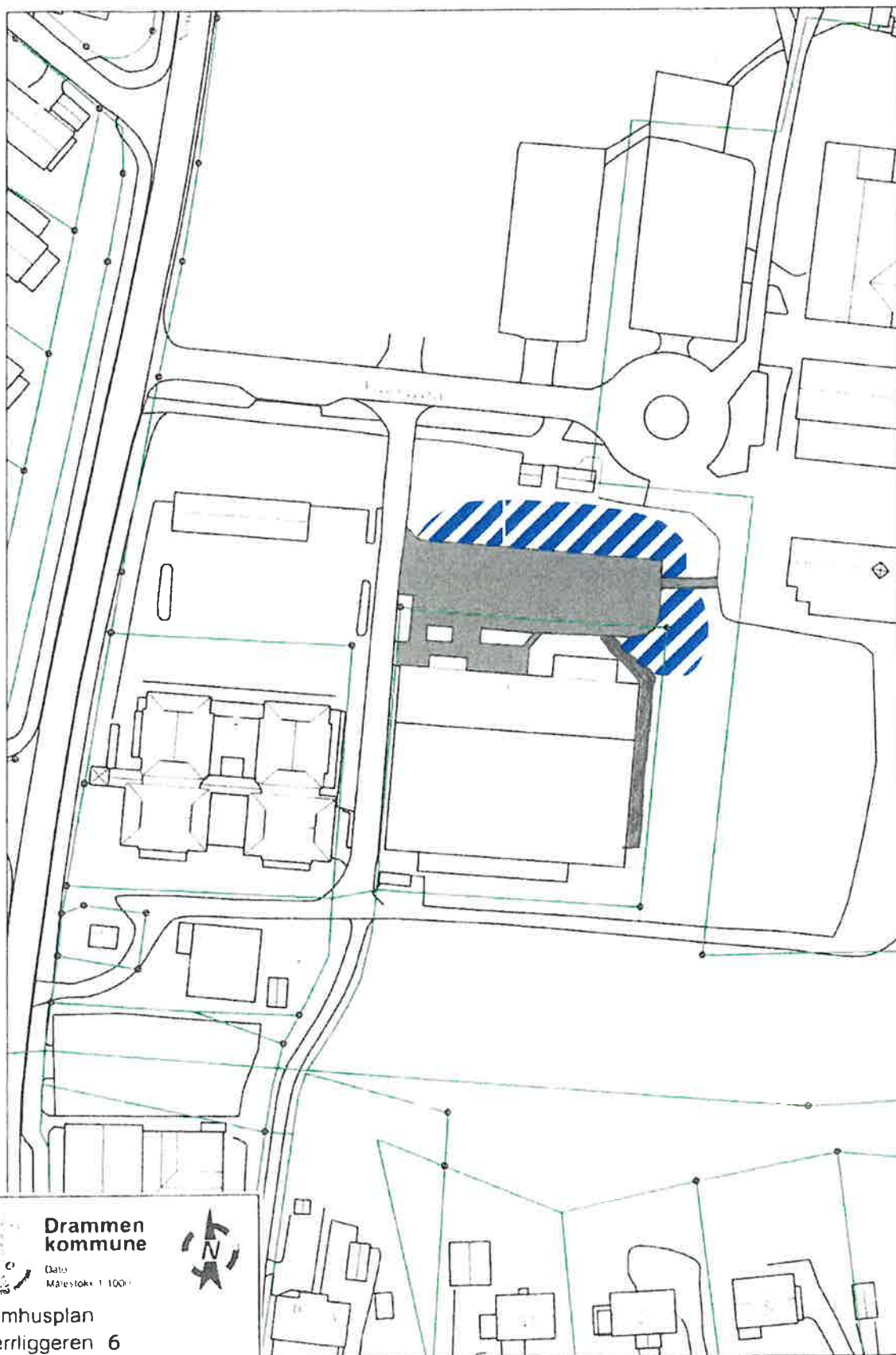



 **Drammen kommune**  
Dato: \_\_\_\_\_  
Målestokk: 1:1000



Utomhusplan  
Tverrliggeren 6  
Glassverket idrettshall

Oppdatert 24.05.24



 <p><b>DRAMMEN KOMMUNE</b></p>	<h2>Kvarter Helleristningen</h2>	
	<p>Helleristningen 26-40</p>	

Målestokk: 1:1000  
Dato: 24/5-2024  
Format A4

Det tas forbehold om evt. feil/mangler i kartgrunnlaget. I forbindelse med prosjektering/anleggsarbeid må aktuelle faginstans i kommunen kontaktes.